

KEY:

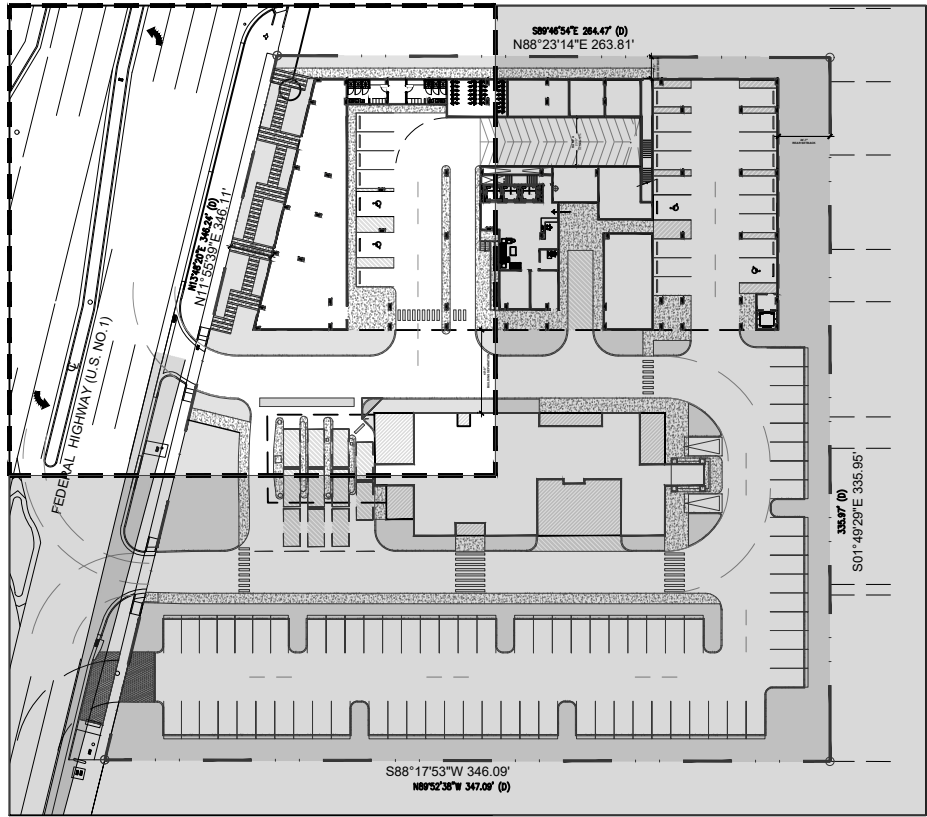

**absolute-idea.com**  
CANAL PARK  
3323 NE 163rd Street, Suite 200 North Miami Beach, FL 33160  
305.792.0015 305.931.0279 info@absolute-idea.com

SEAL  
KEN GARDNER  
FLA 1569

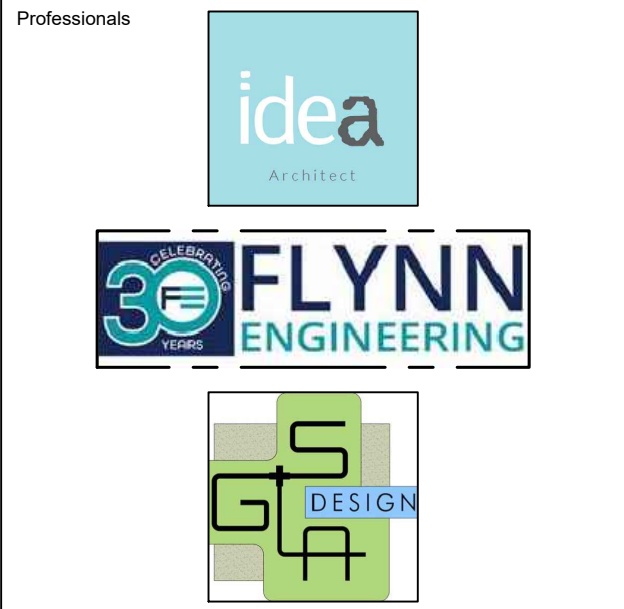

REV.	DATE	DESCRIPTION
01	XX-XX-2024	D.R.C SUBMITAL

ALL MEASUREMENTS MUST BE VERIFIED BEFORE BEGINNING THE WORKS. NO MEASUREMENTS ARE TO BE SCALED DIRECTLY FROM THIS DRAWING.

Key section  
**PROGRESS SET**

Client  
**VERA FUND**  
NICK POLYUSHKIN  
& YURI KHARITONENKOV  
TEL: 305.833.3303

Project  
**1600 S FEDERAL HIGHWAY  
(MIXED-USE PROJECT)**  
1600 SOUTH FEDERAL HIGHWAY,  
POMPAHO BEACH, FL 33062

PLANTING PLAN GROUND FLOOR			
Drawn	Field	Verified	Scale
GSLA	LANDSCAPE ARCH	KG	as shown
Approved	Date	KG	10-09-2024
Project Manager	Dwg. no.	KG	L-201
Project	24-838		

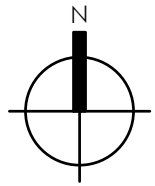

PLANTING PLAN - GROUND FLOOR

